

Fresco Mini Plus Fountain  
User Manual

宠物自动饮水机  
使用说明书

Model / 型号: WF004

Please read this manual carefully before using.  
Keep the manual in a safe place for future reference.  
使用产品前请仔细阅读本使用说明书并妥善保管

## 01 / Meet Your Smart Fountain

---

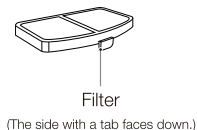
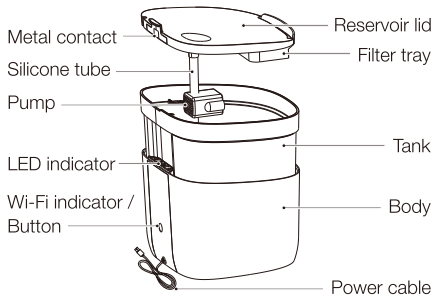

## 02 / Operations

---

### ① Clean up

- Clean the tank and reservoir lid.
- Do not flush the metal contacts directly or soak in the water.
- Soak the filter in the water for 1-3 minutes.
- Clean the body using a dry cloth.

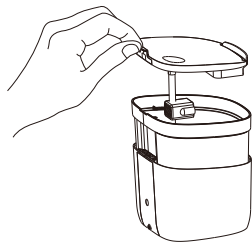

## ② Fill up

Pour water into the tank. Do not exceed the max water level.

\* The first time after fill-up, the pump will automatically extract the air before it pumps water. In this process, the water flow will gradually increase to stabilize.



## ④ Power on

Connect the USB cable to a 5V/1A power supply, then connect A/C adapter to the wall outlet.

The fountain starts working, after the indicator flashes in red and blue alternatively once.

\* USB Power Adapter is not included.

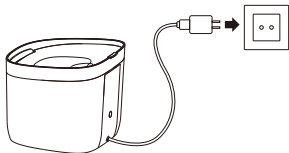

## ③ Assemble

Please put the tank, reservoir lid and filter the right places according to the illustration.

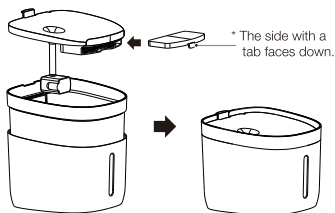

## ⑤ Filter replacement

It is recommended to replace the filter every 30 days!

\* Soak the filter in the water for 1-3 minutes before use.

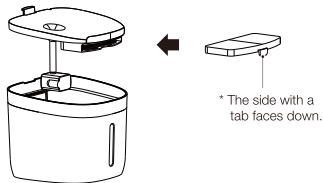

## 03 / Quick Setup

---

1. Scan the QR code on the right and download the Petoneer App which is available on App Store and Google Play . Click Sign up to get walked through to create your Petoneer account.



2. Power on and ensure the Wi-Fi Indicator LED is blinking fast reflecting the device is ready for joining the Wi-Fi.  
Open the Petoneer App and click the '+' button and get walked through the SET-UP steps.

- Notice:**
1. The feeder doesn't support the 5GHz Wi-Fi, please make sure your Wi-Fi is 2.4G.
  2. If the Wi-Fi indicator is not blinking fast after power-on, please long press and hold the button until the indicator blinks quickly.

## 04 / Troubleshooting

---

Problem	Possible reason
Blinking red & no water coming out	The reservoir lid is not placed properly, or the metal contacts are not in place.
	Fountain is out of water, please refill.
Red/Blue flashing alternatively & water not steady coming out	Fountain is running out of water, please refill.

( All Pictures shown in the manual are for illustration purpose only. Actual product may vary due to product enhancement. )

## 05 / LED Status

---

LED Indicator	Steady Blue	Working
	Blinking Blue	The filter has been used for 30 days! Time to change!
	Blinking Red	Low water
	Red/Blue flashing alternatively once	Self-test on power-up
Wi-Fi Indicator	Fast Blinking (3 times/second)	Ready for set-up in SmartLink mode
	Slow Blinking (1 time/2second)	Ready for set-up in AP mode
	Steady On	Device has properly been setup
Button	Short press when blinking blue	Reset filter
	Long press for 5 seconds	Factory reset (Wi-Fi LED blinking fast)
		Switch between SmartLink and AP modes
Specification	Model: WF004 Input: DC 5V 1A Capacity: 1.9 L Cable Length: 3.9 ft (1.2m)	Size: 7.09x6.89x5.79 Inches (180x175x147 mm) Weight: 26.46 oz (750 g) Communication: Wi-Fi (2.4 GHz)

## 06 / Precautions

---

1. Please use it in the indoor environment.
2. When cleaning the fountain, DO DISCONNECT the power supply. Do not flush the metal contacts directly or soak in the water. Clean the body using a dry cloth.
3. Do keep the contacts DRY. If the contacts are dirty, wipe them with a cloth.
4. Children must use the unit under the guidance of an adult.
5. Please place the unit on the flat ground to prevent accidental overturning, causing the fountain to sprinkle or not work correctly.
6. Please shield or organize the power cord well to prevent the pet from biting the cable.
7. This fountain is suitable for cats or small and medium-size dogs.

## 07 / Warranty Terms

---

Within the period of warranty, if the product fails with no fault of user operations, it will be repaired at Petoneer's expense. Product failure in examples below will not be covered by the warranty:

1. Intentional damage to product by the user or third party.
2. Failure to operate or maintain the product following the Quick Installation Guide (QIG) instructions.
3. Failure by natural wear and tear including but not limited to scratching, corrosion, oxidation and rusting.
4. Failure by non-authorized repair of the product including but not limited to user's own or third-party repairing attempts or modifications.

## 08 / Certifications

---

### **FCC Note:**

This device complies with part 15 of the FCC Rules. Operation is subject to the following two conditions:

- (1) This device may not cause harmful interference, and
- (2) this device must accept any interference received, including interference that may cause undesired operation.

**Note:** The Grantee is not responsible for any changes or modifications not expressly approved by the party responsible for compliance. such modifications could void the user's authority to operate the equipment.

**Note:** This equipment has been tested and found to comply with the limits for a Class B digital device, pursuant to part 15 of the FCC Rules. These limits are designed to provide reasonable protection against harmful interference in a residential installation. This equipment generates, uses and can radiate radio frequency energy and, if not installed and used in accordance with the instructions, may cause harmful interference to radio communications.

However, there is no guarantee that interference will not occur in a particular installation. If this equipment does cause harmful interference to radio or television reception, which can be determined by turning the equipment off and on, the user is encouraged to try to correct the interference by one or more of the following measures:

- Reorient or relocate the receiving antenna.
- Increase the separation between the product and receiver.
- Connect the product into an outlet on a circuit different from that to which the receiver is connected.
- Consult the dealer or an experienced radio/TV technician for help.

**Warning:** Changes or modifications not expressly approved by the party responsible for compliance could void the user's authority to operate the product.

### **FCC Radiation Exposure Statement:**

The equipment complies with FCC Radiation exposure limits set forth for uncontrolled environment. This equipment should be installed and operated with minimum distance 20cm between the radiator and your body.

### **Environmental Conditions**

Operating Temperature: 32 °F to 104 °F, (0 °C to 40 °C) (indoor only)

SkyRC Technology Co., Ltd. declares that this Fresco Mini Plus Fountain(WF004), is in compliance with the essential requirements and other relevant provisions of the Radio Equipment Directive (2014/53/EU).

### **Environment friendly disposal**

You can help protect the environment!

Please remember to respect your local regulations: dispose of nonfunctional electrical equipment with an appropriate waste disposal center.



### **Manufacturer: SkyRC Technology Co., Ltd.**

4, 5, 8 Floor, Building 4, Meitai Science Park, Guanguang Road, Guanlan, Longhua District, Shenzhen, China.

### **Read all the instructions**

When using electrical appliances, basic safety precautions should always be followed, including the following:

1. Do not touch hot surfaces. Use handles.
2. To protect against electric shock do not immerse cord, plug into water or other liquid.



3. Close supervision is necessary when any appliance is used by or near children.
  4. Unplug from outlet when not in use and before cleaning. Allow to cool before putting on or taking off parts, and before cleaning the appliance.
  5. Do not operate any appliance with a damaged cord or plug, should the appliance malfunction, or if it has been damaged in any manner. Return appliance to the nearest authorized service facility for examination, repair or adjustment.
  6. The use of the accessory attachments is not recommended by the appliance manufacturer as it may cause injuries.
  7. Do not use outdoors.
  8. Do not let the cord hang over edge of table or counter, or touch hot surfaces.
  9. Do not place on or near a hot gas or electric burner, or in a heated oven.
  10. Always attach plug to appliance first, then plug cord into the wall outlet.
  11. Do not use the appliance for other than intended use.
  12. WARNING: Never leave the appliance unattended whilst in use.
  13. Warning: keep the supply cord away from heating tip and metal enclosure while using.
  14. This appliance is not intended for use by persons (including children) with reduced physical, sensory or mental capabilities, or lack of experience and knowledge, unless they have been given supervision or instructions concerning use of the appliance by a person responsible for their safety.
  15. Children should be supervised to ensure that they do not play with the appliance.
  16. If the SUPPLY CORD is damaged, it must be replaced by the manufacturer, its service agent or similarly qualified persons in order to avoid a hazard.
  17. WARNING: This tool must be placed on its stand when not in use.
- SAVE THESE INSTRUCTIONS.

All Pictures shown in the manual are for illustration purpose only.  
Actual product may vary due to product enhancement.

## 01 / 产品概览

---

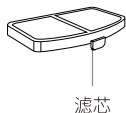
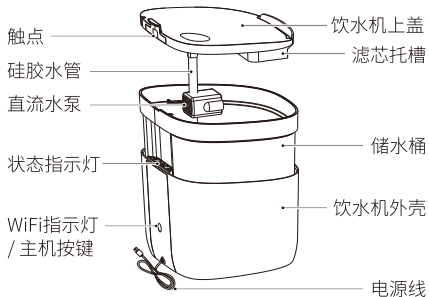

(安装时, 注意滤芯卡口朝下)

## 02 / 使用操作

---

### ① 清洗

清洗储水桶和上盖, 请勿直接冲洗触点或泡入水中。滤芯需用清水浸泡1~3分钟, 水机外壳请用干燥抹布进行清理

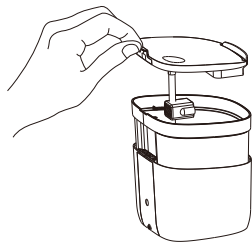

## ② 加水

将水倒入储水桶中，加水量不要超过水位线。（加水后首次使用，水泵会先自动排出空气才上水。此过程水流将逐渐变大至稳定出水。）



## ③ 组装

将储水桶、上盖、滤芯依次组装后放入水机外壳中。

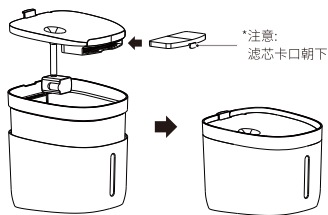

## ④ 连接电源

将水机电源线与适配器连接，并接通电源。指示灯红蓝交替闪烁一次，水机开始工作。

\*不包含USB电源适配器

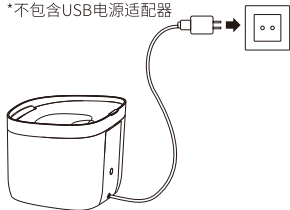

## ⑤ 更换耗材

建议每30天更换一次滤芯。

\*注意：滤芯使用前需用清水浸泡1-3分钟。

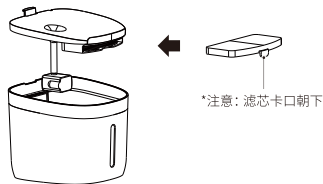

## 03 / 快速添加设备

---

1. 扫描右侧二维码，按照提示下载安装“Petoneer”APP，并注册登陆账号。
2. 通电后，Wi-Fi指示灯快闪，进入配置模式  
请打开“Petoneer”APP，点击“+”按照提示进行设置。



- 注意：(1) 喂食器不支持5GHz路由器，请使用2.4GHz路由器  
(2) 若通电开机后Wi-Fi指示灯不在快闪状态，请长按按键，直至指示灯快闪

## 04 / 故障排除

---

性能故障	故障原因
指示灯红色闪烁，饮水机不出水	上盖可能没有放好，触点没有接触到位
	目前处于缺水状态，请及时加水
蓝灯与红灯交替闪烁，饮水机间歇出水	饮水机即将缺水，请及时加水

(为了提供更好的产品，我们会定期进行产品改良。产品实物可能与说明书有差异。)

## 05 / 按键指示灯与参数

状态指示灯	蓝灯常亮	工作中
	蓝灯闪烁	滤芯已使用30天，提示您更换滤芯
	红灯闪烁	缺水提醒
	红蓝交替闪烁一次	开机自检/滤芯使用寿命重置成功
WiFi指示灯	快闪(3次/1秒)	WiFi模块处于SmartLink状态待加网
	慢闪(1次/2秒)	WiFi模块处于AP状态待加网
	常亮	设备成功连入路由器
主机按键	蓝灯闪烁时短按	重置滤芯寿命
	长按约5秒	恢复出厂设置 (WiFi灯快闪) 切换WiFi加网状态SmartLink加网与AP加网状态
基本参数	产品型号: WF004 输入电源: 5V=1A 储水容量: 1.9L 电源线长: 1.2m 保修期: 1年	产品尺寸: 180×175×147mm 产品净重: 750g 通信方式: WiFi (2.4GHz) 执行标准: Q/TK 001-2019

## 06 / 注意事项

---

1. 请在室内环境使用
2. 进行整机清理工作时，请断开电源，请勿直接冲洗触点或泡入水中；水机外壳请用干燥抹布进行清理
3. 儿童需在成人指导下使用
4. 请放置在水平地面上，以防不慎打翻，导致设备洒水或不正常工作
5. 请做好电源线遮挡或收纳，以防宠物撕咬电线
6. 本机适用于猫或中小型犬。

## 07 / 保修条款

---

在保修期限内，对于正常使用Petoneer产品过程中，由于非人为导致的损坏，所产生的维修费用和 Related 的人工费用，由Petoneer承担。以下情况导致的维修不在保修条款包含中：

1. 故意行为导致的损坏
2. 未按照产品使用说明书指引使用、保养该产品
3. 设备正常磨损、腐蚀、氧化、锈垢、耗损等原因导致的损失
4. 因在非Petoneer授权维修代理店或用户自身进行维修、改造、清洗而造成的损坏。

制造商：天空创新科技（深圳）有限公司

制造地址：深圳市龙华区观澜街道桂花社区观光路美泰工业园4栋4,5,8层

